

SUMMER CLASSICS®

TEAK

Maintenance, Cleaning, & Care



Summer Classics teak furniture is made of the highest quality slow-growth, plantation-raised teak the premier wood for use in outdoor furniture. The high oil and rubber content in teak offers superior protection from water absorption and rotting, ensuring years of worry-free enjoyment. Teak's naturally occurring oils can reveal slight red, green, brown, or yellow color variations in the wood that give each piece unique characteristics. As it ages, unfinished teak will soften to a beautiful gray patina. This is a natural process and is due to the loss of natural oils in the wood. For best results, wipe down your teak furniture and store cushions separately for the first year to minimize the chance for teak oil to stain the cushions as this is not covered by our warranty for frames or cushions.



TEAK CARE & CLEANING QUICK REFERENCE GUIDE

MAINTENANCE:

- Do not use Teak Cleaner on any type of finished teak, this includes SC Oyster Teak finish; it will remove the finish.
- Teak Shield is safe to use on both natural and finished teak. When applied to teak furniture, it will minimize—but not completely eliminate—the natural movement of teak oil from the wood surface to the cushions.
- Teak is naturally resistant to termites and other wood-eating insects due to its silica content.
- For regular maintenance, wipe down the furniture with a soft cloth, using mild soap and warm water. Never use a hard brush or pressure washer on Oyster teak as it will wash away the teak oil and the primer.

STORAGE:

- Store cushions separately for the first year to minimize the chance of teak oil staining the cushions, as this is not covered by our warranty.
- Once the seat and back develops a silver-gray patina it will no longer be necessary to store cushions separately.

TEAK AGING:

- Teak ages over time and needs to be cleaned and treated twice a year – Spring and Fall at a minimum.
- Teak furniture will gradually develop a beautiful, soft gray patina. Depending on the environment, color changes due to natural graying and weathering may become noticeable after a few months of use. In drier climates, teak will take several months to weather.
- Over time all teak products will have black spots and checking (small cracks in the wood). These are not defects but are a natural part of the teak acclimating to its new environment.



CARE & MAINTENANCE

Summer Classics offers two types of Teak:



#4 NATURAL TEAK

Natural Teak is unfinished teak wood without any sealer or stain. The high oil content in teak makes this wood ideal for outdoor use, especially oceanfront environments. The teak oil can have slight color variations ranging from green, red, brown, and yellow. With the natural weathering of the wood, the teak oil will move unevenly through the wood, creating color variations over time that enrich the unique finish of this durable wood.



#27 OYSTER TEAK FINISH

Oyster Teak is Natural Teak with a hand-applied, oil-based finish that gives the soft gray patina of aged teak. Raw, young teak wood is intentionally distressed to achieve a richly aged texture and to create an ideal base for the multilayered Oyster Teak finish.



Each component and product may respond differently to environmental conditions causing one piece to darken or gray more than another. During the weathering process, teak will sometimes check along the grain lines; this is perfectly natural and does not affect the structure of the product. Periodic cleaning and/or protection will help to maintain a smooth appearance. Teak is a sturdy, durable wood. Color variations and the patina that results from weathering enhance the beauty of the wood without compromising the integrity of the piece.



DE-COLORIZATION OF TEAK OVER TIME:

Please note:

- Teak Shield is safe to use on both natural and finished teak. It will minimize but not completely eliminate the movement of teak oil from the wood surface to the cushions.
- Teak Protector contains pigment to maintain the honey-brown color of natural teak. If used on finished teak, the protector can change the finish to have a yellowish undertone. It is recommended for use only on Natural Teak products.
- Teak Cleaner is designed to be used only on Natural Teak. It should never be used to maintain finished teak, including products with Oyster Teak finish.

Teak de-colorization occurs naturally with exposure to environmental elements and does not affect the structural integrity of the product. The diagram below is an estimate and will vary based on geographic location and climate.

NEW TEAK



OLD TEAK





CARE & MAINTENANCE



FREQUENTLY ASKED QUESTIONS ABOUT TEAK & CLEANING

What's the advantage of teak outdoor furniture?

Teak is the premier wood to use in outdoor furniture due to its high oil and rubber content, which makes the wood durable and helps prevent rotting. Plus, teak is naturally resistant to termites and other wood-eating insects due to its silica content.

How will teak furniture weather outside?

- Teak furniture is perfectly suited for use in any outside environment—even waterfront settings—and will gradually develop a beautiful, soft gray patina. Teak wood is known for its superior durability, stability, and low maintenance.
- Teak reacts to outdoor elements such as humidity, dampness, light, and moisture just like wooden porches, doors, framing, banisters, and railings do. Depending on the environment, color changes due to natural graying and weathering may become noticeable after only a season of use. In drier climates, teak will take several months to weather. If the wood is exposed to infrequent moisture, the color will fade slowly with only minor discoloration. In moist climates where furniture is subjected to regular dew and sunshine, teak wood will weather more quickly. Not all pieces that are in the same location will weather at the same rate.

If I prefer the honey-brown color of unfinished teak, how do I retain this color?

- If you notice checking (small cracks in the wood) or graying—both normal weathering for teak—our Teak Cleaner can be used to restore the golden color. (Do not use Teak Cleaner on finished teak.)
- For regular maintenance, wipe down the furniture with a soft cloth, using mild soap and warm water. Once the furniture has dried, you can apply our Teak Protector to retain the honey-golden color of natural unfinished teak (we recommend doing this twice a year—spring and fall). The Protector replenishes the teak oil in the drying wood and restores the honey-golden color. **BE SURE TO APPLY TO ALL TEAK SURFACES, EVEN THE UNDERSIDES!**

Why are there color variations in my teak wood furniture?

Teak is a natural product with inherent characteristics. Just as no two handmade or hand-touched products are exactly alike, no two teak wood slats are identical. Each component

is cut at different times from different areas of aged trees. To create longer planks of teak and reduce waste, a finger joint will be used and is not to be confused with mortise and tenon joints. (See example below).

Will my teak furniture with a factory-applied finish weather?

- Even with finished teak products, the wood's oil will migrate to the surface and into the finish. Expect some of this oil to bleed out following the first few rainfalls. In order to protect your cushions, bring them inside before the furniture gets wet. Once the seat has begun to develop a silver-gray patina it's no longer necessary to bring the cushions inside.
- The oil can also move the white primer to the surface of the product, which may change or lighten the finish color. This is a natural attribute of teak and doesn't diminish the durability of the piece.

What are some good tips for protecting my cushions from teak oil stains?

- Staining from naturally occurring teak oil may result on cushions left on teak furniture before the silver-gray patina develops. For best results, wipe down your teak furniture with a damp cloth. Store cushions separately for the first year to minimize the chance for teak oil to stain the cushions, as this is not covered by our warranty for frames or cushions.
- For added protection, Teak Shield is safe to use on both natural and finished teak. When applied to teak furniture, it will minimize—but not completely eliminate—the natural movement of teak oil from the wood surface to the cushions.
- Once the seat and back have begun to develop a silver-gray patina, it's no longer necessary to bring the cushions inside.

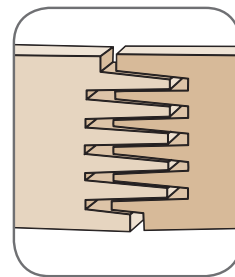

FINGER JOINT

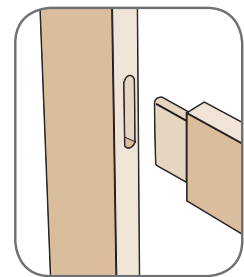

MORTISE & TENON JOINT



FREQUENTLY ASKED QUESTIONS ABOUT TEAK & CLEANING

What's the best way to maintain the Oyster Teak Finish?

- The teak oil finish on the Oyster Teak products forms a thin film coating that allows the wood to breathe, enabling the oil and the primer to seep into the wood pores. For regular maintenance, use a soft cloth with mild soap and water to wash the furniture. Never use a hard brush or pressure washer as it will wash away the teak oil and the primer.
- Finished teak is recommended for use in covered outdoor settings. When the furniture is not in use, furniture covers will help prolong the finish. The factory-applied finish will begin to weather after about a season of use and won't necessarily wear away in an even fashion. Once this starts to occur, the unfinished teak will be exposed and will weather naturally, acquiring the gray patina that's a distinguishing feature of untreated teak wood.

I have black spots on my teak furniture. Is it mold?

- Over time all teak products will have black spots and checking (small cracks in the wood). These are not defects but are a natural part of the teak acclimating to its new environment. Teak wood will not mildew; however, mildew can grow on dirt and other foreign substances that are not removed from the wood. This occurs more commonly in warm, humid climates. It is recommended to follow standard teak cleaning procedures as soon as black spots form; otherwise, stains may form and become difficult to remove from the wood.
- Periodic cleaning of the furniture surface will remove environmental deposits that could promote mildew growth. For light cleaning, wipe down the furniture using mild soap, warm water, and a soft cloth. Rinse with a hose, using gentle pressure to remove the soap. Allow to air dry. Applying Teak Shield has also been shown to impede mildew growth.

Is it okay to sand teak furniture?

If you have a rough area on a natural teak product and prefer smooth teak you can use a fine grit sandpaper or a piece of standard cardboard to sand the wood to a smooth touch. Do not use power sanding as the heating may cause dark marks on the wood. Also, do not sand pieces with an Oyster Teak finish as you will sand off the finish.

How often do I need to clean my teak furniture?

Teak ages over time and needs to be cleaned and treated twice a year at a minimum.

How do I clean teak?

- Periodic cleaning will help maintain your teak furniture and keep it looking good for years. For general cleaning (recommended twice a year), hose down the furniture with a water hose, using gentle pressure (high pressure can erode the wood surface). Scrub the wet furniture using a soft bristle brush and a solution of $\frac{2}{3}$ cup laundry detergent in 1 gallon of warm water. Rinse the entire piece with fresh water to remove any remaining cleaning solution.
- For more intensive cleaning, Summer Classics has several products that are specially designed to make upkeep easy. Be sure to clean all teak products on a disposable plastic or thick fabric drop cloth. This will prevent you from staining or damaging the surface under the product being cleaned. Contact with the Teak Cleaner, Protector, or Shield may affect grass, plants, and some types of flooring or pavement.

Is it safe to use your products on all teak furniture?

Please refer to our how-to section for detailed directions before beginning. Teak Protector, for example, can give a yellowish undertone to finished teak. Teak Cleaner should be used on natural (unfinished) teak only. Only clean finished teak—including our Oyster Teak—with a soft cloth and mild soap and water. Harsh cleaners can remove the finish from the teak.

How do I apply the cleaning products?

For best results, follow the directions on the bottle. A few tips to remember: Do not use a spray bottle to apply Teak Cleaner, Protector, or Shield because you may over-apply to an area and create chipping and wood bubbling. Do not clean our teak products with a pressure washer, even on the lowest setting. This will remove the finish on the painted teak or damage the weathering patina on natural teak.

Is there a recommended sequence for applying the cleaning and wood treatments?

To clean Natural (unfinished) Teak pieces, begin with Teak Cleaner. (Do not use Teak Cleaner on Finished Teak! It will remove the finish.) To maintain the honey-brown color of Natural Teak, follow cleaning with Teak Protector. To help repel water and prevent stains, apply Teak Shield over Teak Protector. Do not apply Teak Protector over Teak Shield as Teak Shield will prevent Teak Protector from penetrating the wood.



CARE & MAINTENANCE





Teak Care & Maintenance Products

PROTECTOR | PNT-00360

Maintains the original honey-brown color of Natural Teak for a longer time.

SHIELD | PNT-00361

Makes teak and other hardwoods resistant to water and moisture. Helps prevent food and drink stains.

CLEANER | PNT-00359

A cleaner and brightener in one. It restores Natural Teak. Do not use on finished teak.

THERE ARE SEVERAL WAYS TO MAINTAIN TEAK:

FINISHED TEAK (OYSTER TEAK)

- CLEAN FINISHED TEAK WITH MILD SOAP ONLY AND A SOFT CLOTH

NATURAL TEAK

- ALLOW TO WEATHER NATURALLY
- CLEAN REGULARLY
- APPLY TEAK CLEANER
- APPLY TEAK PROTECTOR
- APPLY TEAK SHIELD

NATURALLY AGED TEAK

- ALLOW TO WEATHER NATURALLY
- CLEAN REGULARLY WITH MILD SOAP AND WATER

ANY TYPE OF FINISHED TEAK (INCLUDING OYSTER TEAK)



TEAK SHIELD PNT-00361

Makes teak and other hardwoods resistant to water and moisture. Helps prevent food and drink stains. Can minimize but not eliminate the movement of teak oil from the wood to the cushions.

NEW UNFINISHED NATURAL TEAK



TEAK PROTECTOR PNT-00360

Maintains or returns the original honey-brown color of Natural Teak for a longer time. If used on finished teak, the protector can change the finish to have a yellowish undertone.



TEAK SHIELD PNT-00361

Makes teak and other hardwoods resistant to water and moisture. Helps prevent food and drink stains. Can minimize but not eliminate the movement of teak oil from the wood to the cushions.



TEAK CLEANER PNT-00359

A cleaner and brightener in one. It restores Natural Teak. Do not use on finished teak.

NATURALLY-AGED UNFINISHED TEAK



TEAK SHIELD PNT-00361

Makes teak and other hardwoods resistant to water and moisture. Helps prevent food and drink stains. Can minimize but not eliminate the movement of teak oil from the wood to the cushions.



TEAK CLEANER PNT-00359

A cleaner and brightener in one. It restores Natural Teak. Do not use on finished teak.



CARE & MAINTENANCE

ITEMS NEEDED FOR APPLICATION OF PRODUCTS



RUBBER GLOVES



EYE PROTECTION



CLEAN WATER



LIGHT SANDPAPER (fine grit)



FLOOR PROTECTOR (plastic or thick cloth)

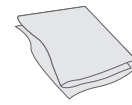

CLEAN CLOTH

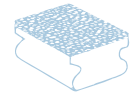

APPLICATION PADS



TEAK PROTECTOR
PNT-00360

HOW TO USE TEAK PROTECTOR TO MAINTAIN NATURAL TEAK'S HONEY-BROWN COLOR:

Allow Teak Protector to fully dry before using furniture. If used before completely dry, clothes or cushions can be stained. Teak Protector should be applied at least once a year.

- Clean with Teak Cleaner (PNT-00359) when teak starts to gray. Allow wood to dry completely after cleaning and before applying Teak Protector. **DO NOT USE TEAK CLEANER ON FINISHED TEAK!**
- Apply Teak Protector (PNT-00360) after Teak Cleaner has dried completely. Apply a very thin layer of Teak Protector over the cleaned area with a dust-free cloth. If you apply too much in one application, a slight color variation may occur.
- Wait 30 minutes, then apply a second thin layer.
- Teak Protector will last four times longer than applied teak oil and two times longer than applied teak sealer. To maintain the natural golden color, apply Teak Protector several times a year. Tabletops will benefit from regular applications.

Note: Teak Protector applied to finished teak may add yellow undertones to the finish.

PROTECTION PLUS

- Teak Protector application is fast and easy.
- 100% water-based so clothes and cushions stay clean. There's no oil or greasy residue. Once dry, it will not stain clothing.
- Resistant to mold and prevents black spots on teak by penetrating into the pores of the wood with unique UV inhibitors and reflectors.



TEAK SHIELD
PNT-00361

HOW TO USE TEAK SHIELD TO MAKE TEAK RESISTANT TO MOISTURE AND STAINS:

Teak Shield is a transparent protective layer that doesn't penetrate the wood. It prevents food and beverage stains, repels moisture and dirt, and reduces mold and mildew.

- Before applying Teak Shield (PNT-00361), allow new products to weather outside for two weeks. For older pieces, clean first with Teak Cleaner (PNT-00359). (Do not use Teak Cleaner on finished teak.) Make sure the wood is 100% clean, dry, and free from dust.
- Sand lightly if cleaned wood has any rough areas. Clean thoroughly before applying Teak Shield. (Note: Sanding finished teak will remove the finish and reveal the raw teak underneath.)
- Apply a thin layer of Teak Shield with a clean, soft cloth. Allow to dry for four hours.
- Apply a second thin layer, after the first layer has been allowed to dry for four hours.
- Wait 48 hours before exposing to moisture.



- TEAK WILL AGE OVER TIME AND WILL NEED TO BE CLEANED AND TREATED ANNUALLY AT A MINIMUM IF YOU REFINISH FIRST FOLLOW THE TEAK CLEANER STEPS, THE TEAK CLEANER WILL REMOVE TEAK SHIELD. AFTER THE WOOD DRIES, IT CAN BE LIGHTLY SANDED IF NEEDED.
- PLACING TEAK SHIELD OVER TEAK PROTECTOR WILL HELP REPEL WATER PENETRATION BUT ONLY FOR A SHORT TIME SINCE THE SHIELD CANNOT SOAK INTO FULLY INTO THE WOOD.
- DO NOT PLACE TEAK PROTECTOR OVER TEAK SHIELD AS SHIELD WILL NOT ALLOW PROTECTOR TO PERFORM PENETRATION.



TEAK CLEANER
PNT-00359

HOW TO USE CLEANER TO MAINTAIN **UNFINISHED** TEAK:

DO NOT USE TEAK CLEANER ON ANY TYPE OF FINISHED TEAK!

Warning: Oyster Teak is a hand-applied, oil-based finish designed to achieve an out-of-the-box, aged teak appearance. The raw teak wood is distressed to achieve the aged texture and to open the pores to create adhesion for the multilayered Oyster Teak finish.

Once you have determined the teak item is 100% unfinished teak, follow the directions below for using this product:

HOW TO USE CLEANER TO MAINTAIN **UNFINISHED** TEAK:

Clean your teak product before winter storage and then prior to regular usage. Once the product is cleaned and completely dry, it may be placed in rain, sun, or snow.

- Prepare the area for teak cleaning, using plastic or a thick cloth to cover the area.
- Moisten the furniture to be cleaned with clean water.
- Apply Teak Cleaner (PNT-00359) with a soft cloth or a clean sponge (use gloves). Allow the cleaner to soak in for 3 minutes.
- Brush the wood clean with the scrubbing pad provided with the teak cleaner bottle or use a soft brush in the direction of the wood grain.
- Allow the cleaner to dry completely. If you prefer the color of new teak, use Teak Cleaner first to restore the color, then apply Teak Protector (PNT-00360) to preserve the color after the cleaner has dried completely. If you only clean the teak wood it will continue to gray and age when exposed to the outdoor environment.

Note:

Black dots, yellowing, dark streaks, and even insects and bugs are part of teak's response to outdoor conditions of rain, heat, and sunlight. Black dots are not considered to be a defect

